

## Mounting Instructions

**Call push button 1-gang for  
flush-mounted outdoor station**

1262 00, 1293 00

**Call push button 3-gang for  
flush-mounted outdoor station**

1263 00, 1294 00

**Information module for  
flush-mounted outdoor station**

1264 00, 1295 00

# GIRA

## Device description

---

The 1 and 3-gang call buttons for the flush-mounted outdoor station and the information module are part of the Gira door communication system and are used to expand the flush-mounted outdoor station.

The basic structure is presented in the example of the call push button 3-gang.

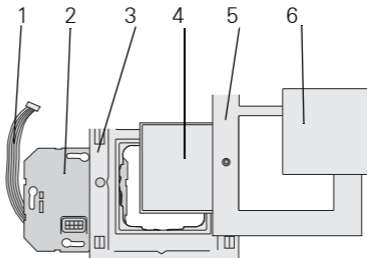

- 1 Audio connection cable
- 2 Call push button insert
- 3 TX\_44 frame bottom section  
(not in scope of supply)
- 4 Call push button or information module  
top unit
- 5 TX\_44 frame top section  
(not in scope of supply)
- 6 Call push button cover



### Attention

Installation and mounting of electrical devices may only be carried out by a qualified electrician.

Do **not** use the sealing rings included with the TX\_44 frame when installing flush-mounted inserts.

The 1 and 3-gang call buttons and the information module are operated together with the outdoor station:

1. Insert the audio connection cable into a system connector of the bus coupler or speech insert of the flush-mounted outdoor station.



### Deactivating call push button illumination

To deactivate the call push button illumination or illumination of the information module continuously, remove the jumpers between BUS and ZV at the bus coupler of the outdoor station.

2. Guide the audio connection cable into the flush-mounted panel box.
3. Insert the audio connection cable into a system connector of the call push button insert.
4. Install the call push button insert.
5. Set the bottom section of the TX\_44 cover frame in place and attach the central inserts to the flush-mounted inserts.
6. Clip on the frame top section and press in the Torx screws.

## Start-up

---

Once you have installed all of the devices (outdoor and home stations, control unit etc.), you can start up the door communication system.

Start-up is described in the system manual included with the control unit.



### **Initiating a call (ringing)**

Press the call push button to trigger a call tone at the assigned home station. The button press is confirmed by an additional acknowledgement tone.



### **Switching light on/off (in conjunction with a switching actuator)**

Press the call push button to switch on light or another device via an assigned switching actuator. The button press is confirmed by an additional acknowledgement tone.

## Changing the label plates

---

To change the label plates, the call push button cover is simply lifted up:

1. Carefully lift up the call push button cover, e.g. with a screwdriver.

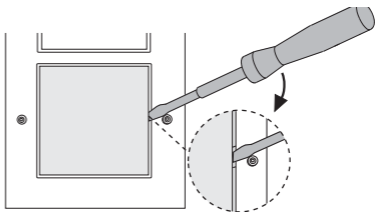

2. Change the label plate.
3. Replace the call push button cover and press on it firmly.

Suitable label plates can be obtained with the optional Gira labelling software and the appropriate Gira labelling sheets.

## Acceptance of guarantee

---

The warranty is provided in accordance with statutory requirements via the specialist trade.

Please submit or send faulty devices postage paid together with an error description to your responsible salesperson (specialist trade/installation company/electrical specialist trade).

They will forward the devices to the Gira Service Center.

Gira  
Giersiepen GmbH & Co. KG  
Elektro-Installations-  
Systeme  
Postfach 1220  
42461 Radevormwald  
Deutschland  
Tel +49 (0) 21 95 / 602 - 0  
Fax +49 (0) 21 95 / 602 - 191  
[www.gira.de](http://www.gira.de)  
[info@gira.de](mailto:info@gira.de)

# GIRA