

Optimal positioning of the finger

Optimal:
place area of greatest fingerprint movement centrally over the sensor.

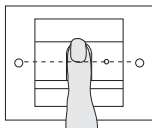

Not so:

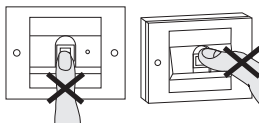

The correct placement of the finger is confirmed with a positive acknowledgement signal (1 long tone + green LED).

Teaching-in a finger

1. Place the finger to be taught-in centrally upon sensor.



2. Shift the finger slightly upwards.



3. Shift the finger slightly downwards.



4. Repeat steps 1-3 until a positive acknowledgement is heard (1 long tone).

✓ If a negative acknowledgement is heard after the seventh attempt (3 short sounds + red LED), the teach-in of the finger was not successful. In this case lay the finger on again (step 1) or use another finger.

41 09 99 12/12

Brief instructions for fingerprint reader

For start-up, the following steps must be implemented in the order shown below:

I. **Install fingerprint reader**
→ LED flashes green

II. **Create first administrator:**

Admin_{NEW} (7x) → Progr._{NEW} (7x)

Create user finger for relay 1/2:

III.

R1 = Admin → Progr. → Admin → User _{NEW} (7x)
R2 = Admin → Progr. → Progr. → User _{NEW} (7x)

IV. **Carry out configurations to fingerprint reader**

V. **Use in door communication system:**
Assign door opener / switching actuators

Management commands

Function	Finger combination	LED	Lay on finger	Tone	Details
Teach-in first administrator		flashes green	Admin _{NEW} (7x) → Progr. _{NEW} (7x)	2 x long	P. 16
Teach-in user finger for relay 1	Admin → Progr. → Admin	orange	User _{NEW} (7x)	2 x long	P. 18
Teach-in user finger for relay 2	Admin → Progr. → Progr.	orange	User _{NEW} (7x)	2 x long	P. 19
Teach-in further administrators	Admin → Admin → Progr.	orange	Admin _{NEW} (7x) → Progr. _{NEW} (7x)	2 x long	P. 20
Delete administrators	Progr. → Progr. → Progr.	flashes red	Admin or Progr.	1 x long	P. 22
Delete user finger	Progr. → Progr. → Progr.	flashes red	User	1 x long	P. 24
Switch illumination on/off	Progr. → Admin → Admin			1 x long	P. 25
Switch acknowledgement tone on/off	Progr. → Admin → Progr.			1 x long	P. 26
Change relay switching times	Progr. → Progr. → Admin	orange	User $\xrightarrow[n \text{ s}]{\text{Switching}}$ User	1 x long	P. 27
Reset to factory settings (delete all)	Admin → Admin → Admin _(5secs.)	flashes green			P. 28

Assignments in door communication system

Function	Start programming mode	LED	Lay on finger	Tone	Details
Assign switching actuator (individual assignment)	Control device → System progr. Switching actuator → Progr.	flashes orange	User	1 x long	P. 32
Assign switching actuator (group assignment)	Control device → System progr. Switching actuator → Progr.	flashes orange	Admin	1 x long	P. 33
Assign door opener (individual assignment)	Control device → System progr. Control device → Door opener progr.	flashes orange	User	1 x long	P. 32
Assign door opener (group assignment)	Control device → System progr. Control device → Door opener progr.	flashes orange	Admin	1 x long	P. 33